

The logo for Wold Architects and Engineers, featuring the word "Wold" in white text on a red, stylized shape.

**Wold**

A photograph of a school gymnasium with children playing. The gym has a polished wooden floor with blue and yellow markings. Several orange cones are placed on the floor. In the background, there is a basketball hoop and a bulletin board with colorful papers. The text "BRENTWOOD ELEMENTARY SCHOOL STUDY" is overlaid in large, white, bold letters.

# **BRENTWOOD ELEMENTARY SCHOOL STUDY**

**COMMUNITY CONSOLIDATED SCHOOL DISTRICT 59**

**WOLD ARCHITECTS AND ENGINEERS | BOARD OF EDUCATION - OCTOBER 23, 2023**





## OUR TEAM



**Mike Eichhorn**  
Principal-in-charge  
Wold Architects & Engineers



**Alison Andrews**  
Educational Planner  
Wold Architects & Engineers



**David Filipowski**  
Project Designer  
Wold Architects & Engineers



COMMUNITY CONSOLIDATED  
SCHOOL DISTRICT 59

## AGENDA

# BRENTWOOD ELEMENTARY SCHOOL STUDY DRAFT 10-23-23

### Agenda:

- Process and Data
- Programmatic Needs
- Options
- Summary Comparison Matrix
- Discussion





RECAP

## BRENTWOOD UTILIZATION PLAN

- Ratio of Enrollment to Potential Capacity is 81% (target ratio is 75%)
- Building SF/student = 133 sf/student
- Mobile classrooms used for Art and Music
- Programs being sent to other schools
- Adequacy compared with a new future-ready elementary school designed today: Brentwood – 58%







COMMUNITY CONSOLIDATED  
SCHOOL DISTRICT 59

RECAP

## BRENTWOOD ELEMENTARY

- Gym undersized - a 2nd gym space is needed
- MPR – size and no servery
- LRC – been encroached into significantly
- Special, ESL and Dual-language needs
- Core and Encore classrooms



BRENTWOOD GYM



BRENTWOOD CAFÉ



BRENTWOOD LRC



COMMUNITY CONSOLIDATED  
SCHOOL DISTRICT 59

## BRENTWOOD STUDY FINDINGS PHYSICAL ASSESSMENT

Team assessed

- structure
- stormwater
- zoning variance process
- site, parking
- mechanical and electrical
- space needs and sizes





COMMUNITY CONSOLIDATED  
SCHOOL DISTRICT 59

# BRENTWOOD STUDY FINDINGS PROGRAMMATIC NEEDS

## Today's Comparisons for discussion:

- Options A, B, C, D, E programs
- Cost
- Park District Property use
- Construction Schedule



### WORKING PROGRAM

	EXISTING BUILDING (as applicable)				MINIMAL IMPROVEMENTS (A1& A2)				PRIORITY IMPROVEMENTS (B1)				PRIORITY IMPROVEMENTS (B2)			
	Qty	Size	Total SF	Comments	Qty	Size	Total SF	Comments	Qty	Size	Total SF	Comments	Qty	Size	Total SF	Comments
<b>GRADE LEVEL INSTRUCTION</b>																
First thru Fifth Grade Classrooms	19	750	14,250 SF	vary in size	20	-	existing to remain		19	-	existing to remain		19	-	existing to remain	
Kindergarten Classrooms (w/ toilet)	2	960	1,920 SF		2	-	existing to remain		2	-	existing to remain		2	-	existing to remain	
Kindergarten Classrooms	1	890	890 SF	(1) w/o toilet	2	1,300	2,600 SF	(2) new w/ toilet	2	1,300	2,600 SF	(2) new w/ toilet	2	1,300	2,600 SF	(2) new w/ toilet
Classroom	0	-	0 SF		0	-	0 SF		1	900	900 SF		0	-	0 SF	
<b>Grade Level Instruction Net Area Total</b>	22	-	17,060 SF		24	-	2,600 SF		24	-	3,500 SF		24	-	3,500 SF	
Missing Textbook Storage	2	-	0 SF		-	-	0 SF		-	-	0 SF		-	-	0 SF	
<b>SPECIAL EDUCATION/INTERVENTION</b>																
ESL Intervention Classroom	4	200	800 SF	vary in size	4	-	existing to remain		4	855	3,420 SF		4	855	3,420 SF	
Math Intervention	2	740	1,480 SF		2	-	existing to remain		2	-	existing to remain		2	-	existing to remain	
Talent Development Program (TDP)	0	-	0 SF	shared w/ conference room	0	-	shared w/ conference room		1	400	400 SF	relocate to ESU spaces	1	400	400 SF	relocate to ESU spaces
Security Room	0	-	0 SF		0	-	0 SF		4	400	1,600 SF	relocate to ESU spaces	4	400	1,600 SF	relocate to ESU spaces
SLP/Intervention Offices	4	130	520 SF	vary in size	4	-	existing to remain		2	-	existing to remain		2	-	existing to remain	
Intervention Office	2	150	300 SF	vary in size	2	-	existing to remain		1	-	existing to remain		1	-	existing to remain	
Library Office	1	160	160 SF		1	-	existing to remain		1	-	existing to remain		1	-	existing to remain	
Speech	1	225	225 SF		1	-	existing to remain		1	-	existing to remain		1	-	existing to remain	
Offices	2	100	200 SF	vary in size	2	-	existing to remain		4	-	relocate to SLP space		4	-	relocate to SLP space	
<b>Special Education Net Area Total</b>	16	-	3,680 SF		16	-	0 SF		20	-	2,275 SF		20	-	2,275 SF	
Missing (or shared) Programmatic Space	2	-	0 SF		2	-	0 SF		-	-	0 SF		-	-	0 SF	
<b>EXPLORATORY</b>																
Art	1	750	750 SF	in mobile	1	900	900 SF		1	900	900 SF		1	900	900 SF	
Music	1	750	750 SF	in mobile	1	900	900 SF		1	900	900 SF		1	900	900 SF	
Gymnasium (existing)	1	2,800	2,800 SF		1	-	existing to remain		1	-	existing to remain		1	-	existing to remain	
Gymnasium (new)	0	-	0 SF		0	-	0 SF		1	3,070	3,070 SF		1	3,070	3,070 SF	
Gym Office	1	160	160 SF		1	-	existing to remain		1	-	existing to remain		1	-	existing to remain	
Gym Storage	1	175	175 SF		1	-	existing to remain		1	-	existing to remain		1	-	existing to remain	
Band/Orchestra	0	-	0 SF	shared w/ conference room	0	-	shared w/ conference room		1	900	900 SF		1	900	900 SF	
LRC	1	2,840	2,840 SF		1	-	existing to remain		1	-	existing to remain		1	-	existing to remain	
LRC Office	1	225	225 SF		1	-	existing to remain		1	-	existing to remain		1	-	existing to remain	
LRC (existing)	0	-	0 SF		0	-	0 SF		0	-	0 SF		0	-	0 SF	
<b>Exploratory Net Area Total</b>	9	-	7,740 SF		9	-	1,800 SF		9	-	6,070 SF		9	-	6,070 SF	
Missing (or shared) Programmatic Space	3	-	0 SF		3	-	0 SF		2	-	0 SF		1	-	0 SF	
<b>BUILDING SUPPORT AND ADMINISTRATION</b>																
Main Office	1	600	600 SF		1	-	existing to remain		1	-	existing to remain		1	-	existing to remain	
Offices	2	150	300 SF		2	-	existing to remain		2	-	existing to remain		2	-	existing to remain	
Nurse	1	270	270 SF		1	-	existing to remain		1	-	existing to remain		1	-	existing to remain	
Conference Room	1	420	420 SF		1	-	existing to remain		1	-	existing to remain		1	-	existing to remain	
Staff Workroom	1	1,400	1,400 SF		1	-	existing to remain		1	-	existing to remain		1	-	existing to remain	
Professional Development (PLC)	0	-	0 SF	shared w/ workroom	0	-	shared w/ workroom		0	-	shared w/ workroom		0	-	shared w/ workroom	
Cafeteria/MDP	1	3,400	3,400 SF		1	-	existing to remain		1	-	existing to remain		1	-	existing to remain	
Warming Kitchen and Severy	1	170	170 SF		1	-	existing to remain		1	-	existing to remain		1	-	existing to remain	
Boiler/Electrical Room	1	1,260	1,260 SF		1	-	existing to remain		1	-	existing to remain		1	-	existing to remain	
Sever Room	1	250	250 SF		1	-	existing to remain		1	-	existing to remain		1	-	existing to remain	
<b>Building Support and Administration Net Area Total</b>			8,140 SF				0 SF				0 SF				0 SF	
<b>TOTAL AREAS</b>																
GRADE LEVEL INSTRUCTION			17,060 SF				2,600 SF				3,500 SF				3,500 SF	
SPECIAL EDUCATION/INTERVENTION			3,680 SF				0 SF				2,275 SF				2,275 SF	
EXPLORATORY			7,740 SF				1,800 SF				6,070 SF				6,070 SF	
BUILDING SUPPORT AND ADMINISTRATION			8,140 SF				0 SF				0 SF				0 SF	
<b>Total Net Square Footage</b>			36,620 SF				4,400 SF				11,845 SF				11,845 SF	
Net/Gross Factor		x	1.48				x	1.10			x	1.12			x	1.23
<b>Total Gross Square Footage</b>			54,148 SF				4,840 SF				13,100 SF				14,300 SF	

Community Consolidated School District 59  
Brentwood Elementary School Study  
Draft: October 23, 2023





# BRENTWOOD EXPANSION DRAFT 10-23-23

## OPTION - A1



- NEW ADDITION: 4,630 SF
- RENOVATION: 0 SF
- NEW PARKING: 0 SPOTS

### CONSIDERATIONS:

- MOBILE CLASSROOMS STAY IN PLACE
- MINIMAL CONSTRUCTION
- EXISTING PLAYGROUND WILL NEED TO BE MOVED/RECONSTRUCTED
- NO GYM ADDITION
- LOWEST COST
- POSSIBLE TO CONSTRUCT DURING SCHOOLYEAR

**\$4.5M**

NOTE: THESE ARE CONCEPT PLANS FOR DISCUSSION PURPOSES ONLY AND HAVE NOT BEEN REVIEWED OR APPROVED BY THE MT. PROSPECT PARK DISTRICT. THIS IS STRICTLY AN EXERCISE TO IDENTIFY ALL POSSIBLE OPTIONS THAT MAY OR MAY NOT EXIST.

1

### BRENTWOOD ELEMENTARY SCHOOL EXPANSION STUDY - OPTION A1

1" = 60'-0"

0 45' 90'





COMMUNITY CONSOLIDATED  
SCHOOL DISTRICT 59

# BRENTWOOD EXPANSION DRAFT 10-23-23

## OPTION - A2



- NEW ADDITION: 4,630 SF
- RENOVATION: 0 SF
- NEW PARKING: 0 SPOTS

### CONSIDERATIONS:

- MOBILE CLASSROOMS REMOVED
- MINIMAL CONSTRUCTION
- EXISTING PLAYGROUND REMAINS IN PLACE
- EXISTING HARDSCAPE WILL NEED TO BE MOVED/RECONSTRUCTED
- NO GYM ADDITION
- LOWEST COST
- POSSIBLE TO CONSTRUCT DURING SCHOOL YEAR

**\$4.5M**

NOTE: THESE ARE CONCEPT PLANS FOR DISCUSSION PURPOSES ONLY AND HAVE NOT BEEN REVIEWED OR APPROVED BY THE MT. PROSPECT PARK DISTRICT. THIS IS STRICTLY AN EXERCISE TO IDENTIFY ALL POSSIBLE OPTIONS THAT MAY OR MAY NOT EXIST.

1

### BRENTWOOD ELEMENTARY SCHOOL EXPANSION STUDY - OPTION A2

1" = 60'-0"





COMMUNITY CONSOLIDATED  
SCHOOL DISTRICT 59

# BRENTWOOD EXPANSION DRAFT 10-23-23

## OPTION - B1

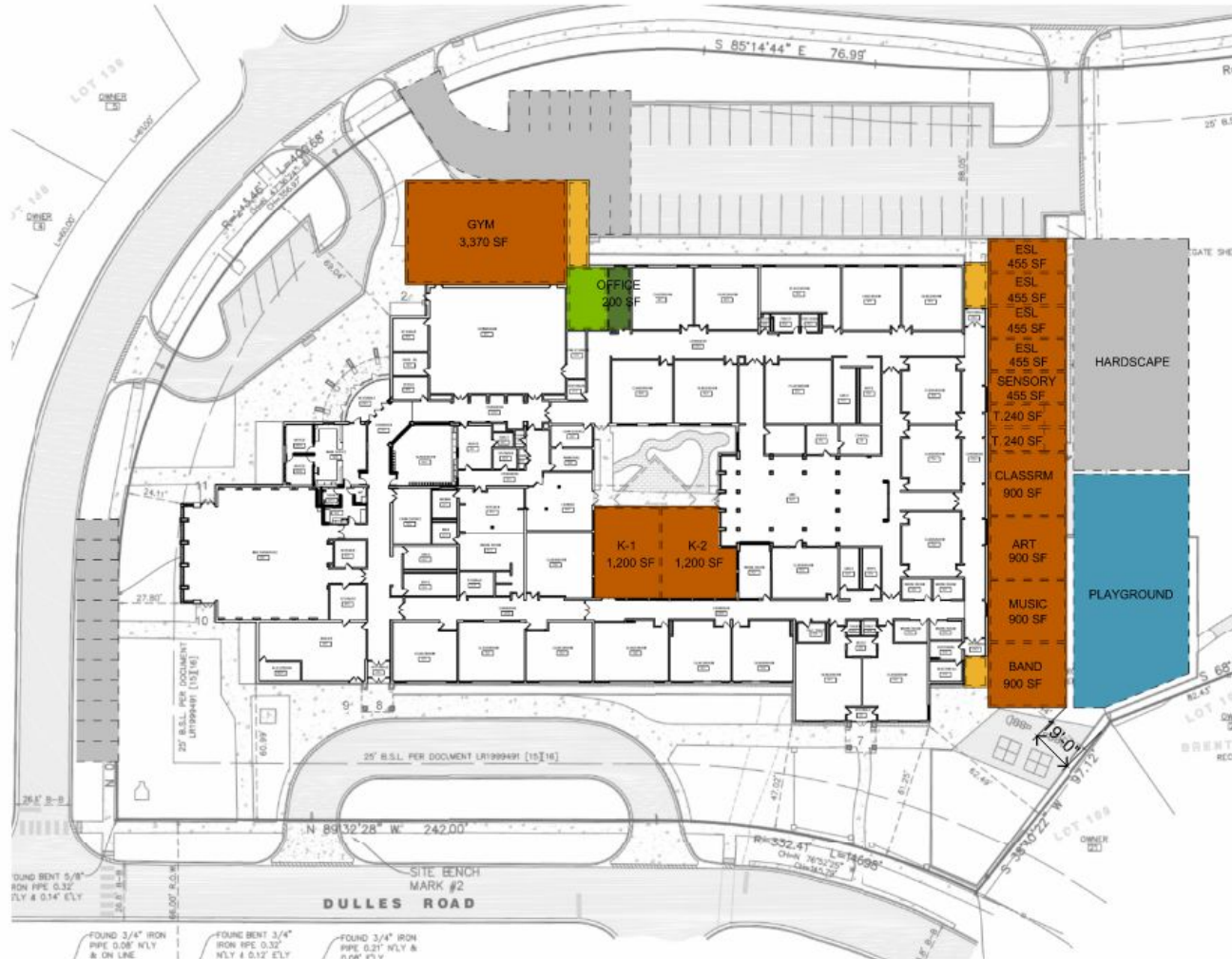

- NEW ADDITION: 13,100 SF
- RENOVATION: 765 SF
- NEW PARKING: 12 SPOTS  
TOTAL PARKING: 63 SPOTS

### CONSIDERATIONS:

- MOBILE CLASSROOMS REMOVED
- KINDERGARTEN CONSTRUCTION IN COURTYARD IS DIFFICULT
- EXISTING PLAGROUND NEEDS TO BE RELOCATED
- GYM IS NOT IDEAL SIZE DUE TO SETBACK (>5,000 sf)
- ADDITIONAL PARKING ALONG BRENTWOOD DR
- PARKING LOT ENTRY NEEDS TO BE REWORKED AROUND NEW GYM

**\$10.5M**

NOTE: THESE ARE CONCEPT PLANS FOR DISCUSSION PURPOSES ONLY AND HAVE NOT BEEN REVIEWED OR APPROVED BY THE MT. PROSPECT PARK DISTRICT. THIS IS STRICTLY AN EXERCISE TO IDENTIFY ALL POSSIBLE OPTIONS THAT MAY OR MAY NOT EXIST.

1

**BRENTWOOD ELEMENTARY SCHOOL EXPANSION STUDY - OPTION B1**

1" = 60'-0"

0 45' 90'





# BRENTWOOD EXPANSION DRAFT 10-23-23

## OPTION - B2

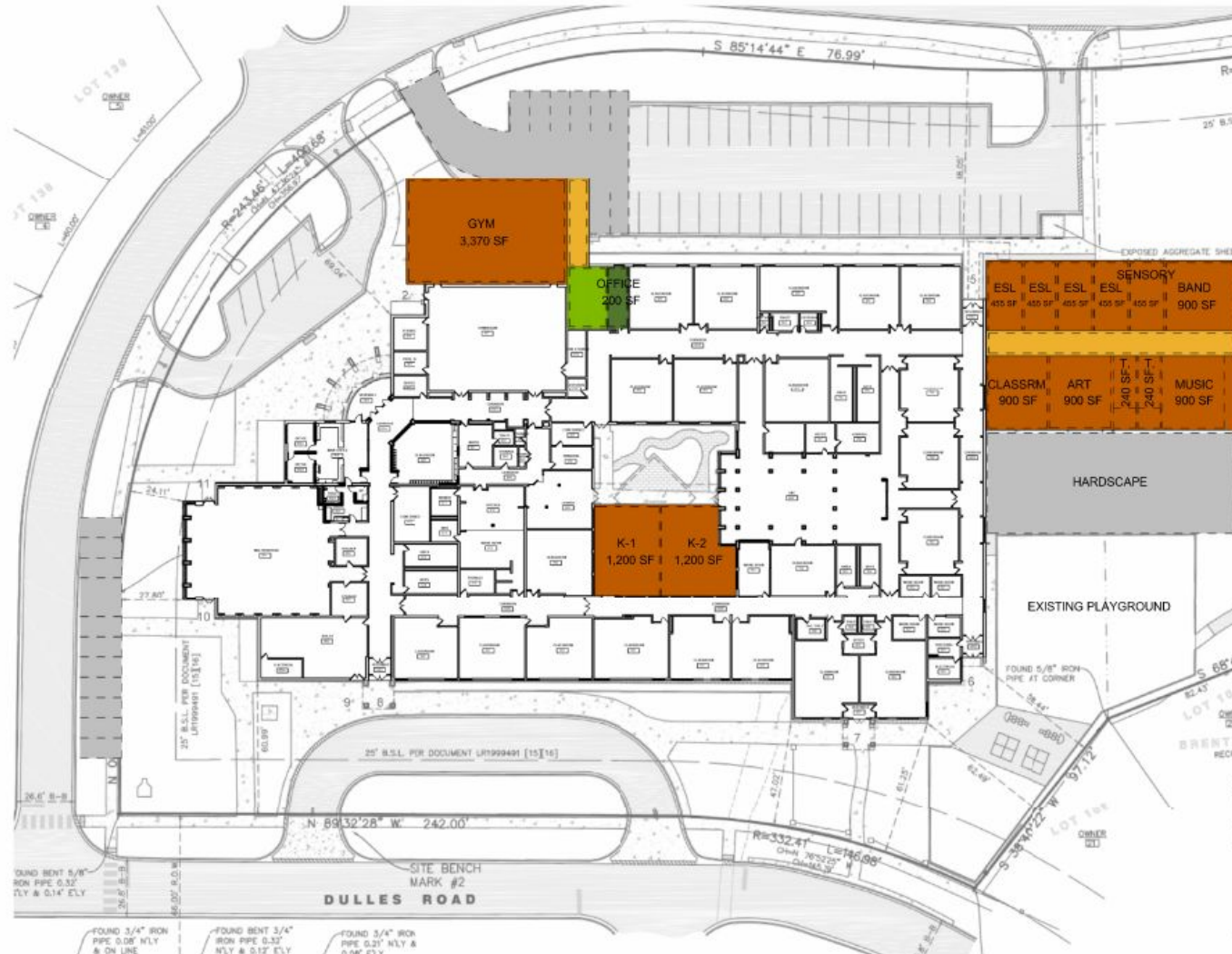

- NEW ADDITION: 14,300 SF
- RENOVATION: 765 SF
- NEW PARKING: 12 SPOTS  
TOTAL PARKING: 63 SPOTS

### CONSIDERATIONS:

- MOBILE CLASSROOMS REMOVED
- KINDERGARTEN CONSTRUCTION IN COURTYARD IS DIFFICULT
- EXISTING PLAYGROUND REMAINS IN PLACE
- GYM IS NOT IDEAL SIZE DUE TO SETBACK (>5,000 sf)
- REQUIRES PURCHASE OF ADJACENT PROPERTY
- ADDITIONAL PARKING ALONG BRENTWOOD DR
- PARKING LOT ENTRY NEEDS TO BE REWORKED AROUND NEW GYM

**\$11.2M**

NOTE: THESE ARE CONCEPT PLANS FOR DISCUSSION PURPOSES ONLY AND HAVE NOT BEEN REVIEWED OR APPROVED BY THE MT. PROSPECT PARK DISTRICT. THIS IS STRICTLY AN EXERCISE TO IDENTIFY ALL POSSIBLE OPTIONS THAT MAY OR MAY NOT EXIST.



# BRENTWOOD EXPANSION DRAFT 10-23-23

## OPTION - C1



NEW ADDITION FIRST FLOOR:  
15,230 SF

RENOVATION FIRST FLOOR:  
3,310 SF

NEW PARKING: 12 SPOTS  
TOTAL PARKING: 63 SPOTS

NOTE: NET ADD FOR OVERALL BUILDING FOOTPRINT: 23,725 SF

### CONSIDERATIONS:

- 2 STORY WILL BE DIFFICULT & EXPENSIVE TO BUILD
- REQUIRES DEMO & RENO AT FIRST FLOOR
- DISPLACE MOBILE CLASSROOMS
- EXISTING PLAYGROUND NEEDS TO BE RELOCATED
- GYM IS NOT IDEAL SIZE DUE TO SETBACK (>5,000 sf)
- FITS WITHIN PROPERTY LINE
- ADDITIONAL PARKING ALONG BRENTWOOD DR.
- PARKING LOT ENTRY NEEDS TO BE REWORKED AROUND NEW GYM
- ADDS KITCHEN & SERVARY
- EXPANDS LRC
- FUTURE READY

**\$22.4M**

NOTE: THESE ARE CONCEPT PLANS FOR DISCUSSION PURPOSES ONLY AND HAVE NOT BEEN REVIEWED OR APPROVED BY THE MT. PROSPECT PARK DISTRICT. THIS IS STRICTLY AN EXERCISE TO IDENTIFY ALL POSSIBLE OPTIONS THAT MAY OR MAY NOT EXIST.

1

BRENTWOOD ELEMENTARY SCHOOL EXPANSION STUDY - OPTION C1 MAIN LEVEL

1" = 60'-0"

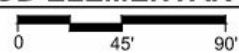





# BRENTWOOD EXPANSION DRAFT 10-23-23

## OPTION - C1

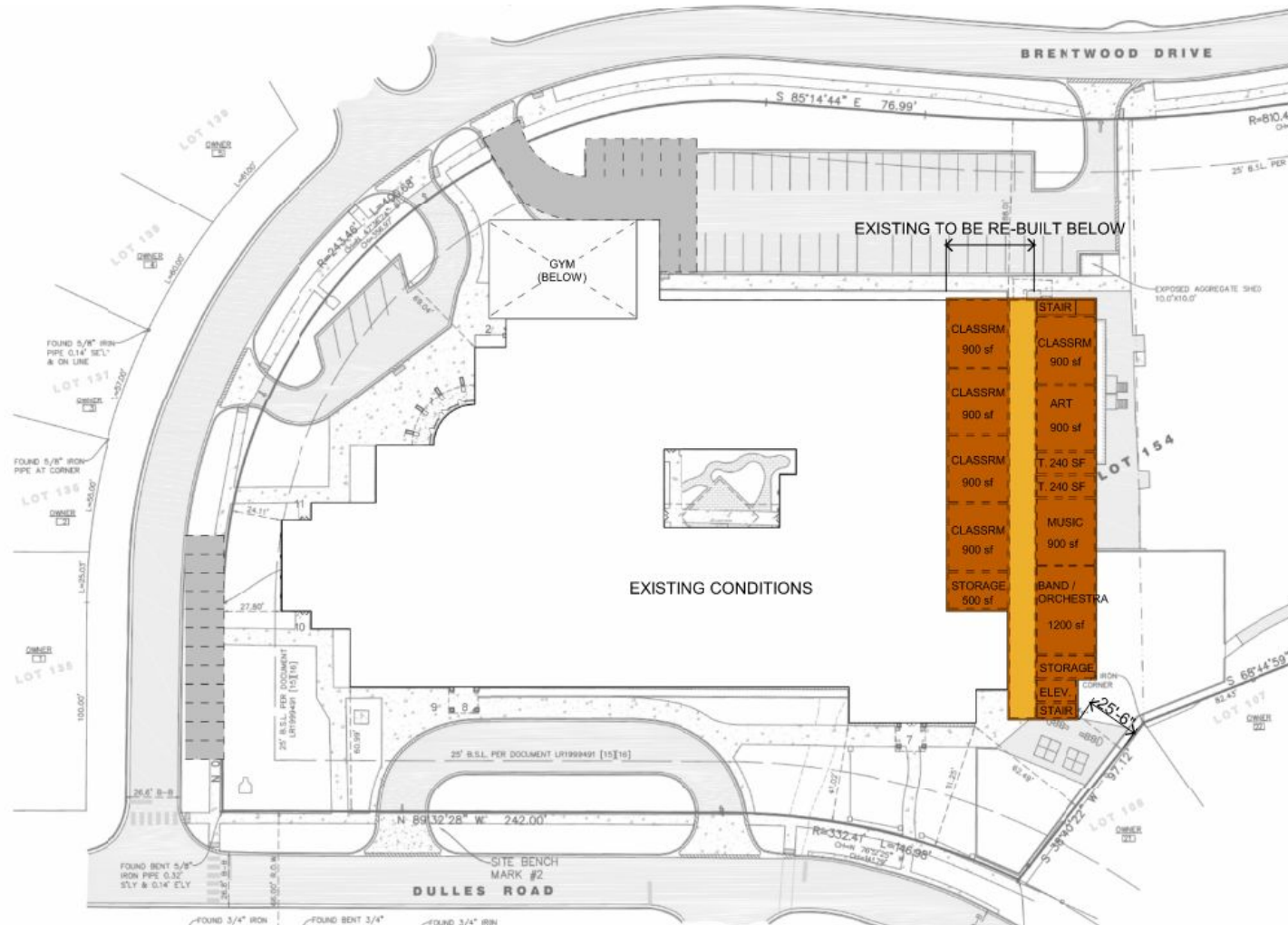

**\$22.4M**

NOTE: THESE ARE CONCEPT PLANS FOR DISCUSSION PURPOSES ONLY AND HAVE NOT BEEN REVIEWED OR APPROVED BY THE MT. PROSPECT PARK DISTRICT. THIS IS STRICTLY AN EXERCISE TO IDENTIFY ALL POSSIBLE OPTIONS THAT MAY OR MAY NOT EXIST.



COMMUNITY CONSOLIDATED  
SCHOOL DISTRICT 59

# BRENTWOOD EXPANSION DRAFT 10-23-23

## OPTION - C2

- NEW ADDITION: 24,700 SF
- RENOVATION: 9,045 SF
- NEW PARKING: 14 SPOTS  
TOTAL PARKING: 69 SPOTS

### CONSIDERATIONS:

- 1 STORY BUILD
- REQUIRES DEMO & RENO AT FIRST FLOOR
- MOBILE CLASSROOMS REMOVED
- SECOND COURTYARD
- EXISTING PLAYGROUND NEEDS TO BE RELOCATED
- FULL SIZE GYM (5,000 SF)
- GYM NEAR PARKING FOR OUTSIDE EVENTS
- PARKING LOT - TO BE EXPANDED
- ADDS KITCHEN & SERVERY
- EXPANDS LRC
- FUTURE READY

**\$22.0M**

NOTE: THESE ARE CONCEPT PLANS FOR DISCUSSION PURPOSES ONLY AND HAVE NOT BEEN REVIEWED OR APPROVED BY THE MT. PROSPECT PARK DISTRICT. THIS IS STRICTLY AN EXERCISE TO IDENTIFY ALL POSSIBLE OPTIONS THAT MAY OR MAY NOT EXIST.



### 1 BRENTWOOD ELEMENTARY SCHOOL EXPANSION STUDY - OPTION C2

1" = 60'-0"

0 45' 90'





COMMUNITY CONSOLIDATED  
SCHOOL DISTRICT 59

# BRENTWOOD EXPANSION DRAFT 10-23-23

## OPTION - C3

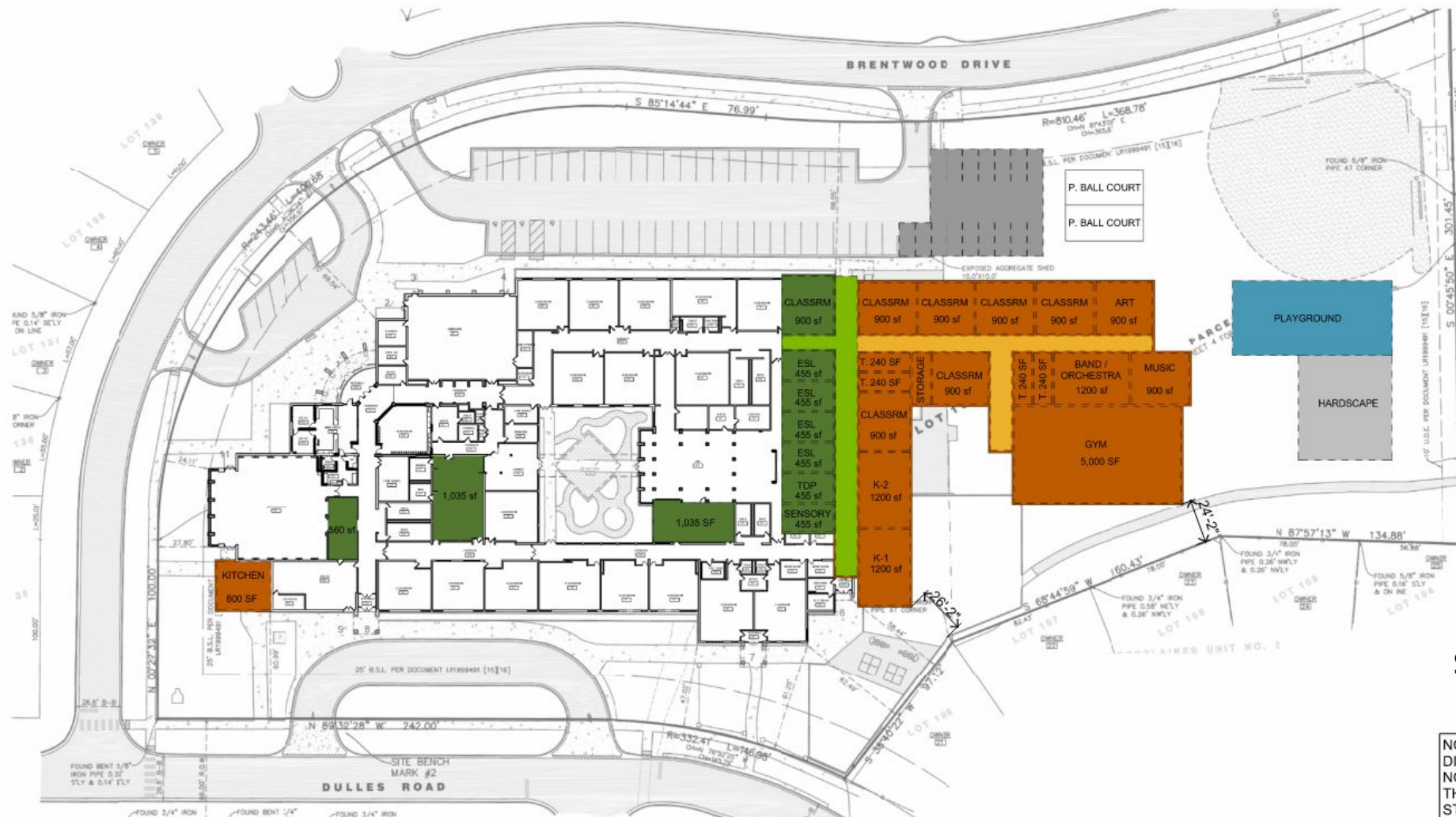

- NEW ADDITION: 21,350 SF
- RENOVATION: 9,045 SF
- NEW PARKING: 14 SPOTS  
TOTAL PARKING: 69 SPOTS

### CONSIDERATIONS:

- 1 STORY BUILD
- REQUIRES DEMO & RENO AT FIRST FLOOR
- MOBILE CLASSROOMS REMOVED
- CIRCULATION NOT IDEAL WITH LONG CORRIDORS
- EXISTING PLAYGROUND NEEDS TO BE RELOCATED
- FULL SIZE GYM (5,000 SF)
- PARKING LOT — TO BE EXPANDED
- ADDS KITCHEN & SERVERY
- EXPANDS LRC
- FUTURE READY

**\$20.8M**

NOTE: THESE ARE CONCEPT PLANS FOR DISCUSSION PURPOSES ONLY AND HAVE NOT BEEN REVIEWED OR APPROVED BY THE MT. PROSPECT PARK DISTRICT. THIS IS STRICTLY AN EXERCISE TO IDENTIFY ALL POSSIBLE OPTIONS THAT MAY OR MAY NOT EXIST.

1

BRENTWOOD ELEMENTARY SCHOOL EXPANSION STUDY - OPTION C3

1" = 60'-0"

0 45' 90'



# BRENTWOOD EXPANSION DRAFT 10-23-23

## OPTION - D1 (3-SECTIONS)



NEW ADDITION: 8,100 SF  
RENOVATION: 6,800 SF  
NEW PARKING: 12 SPOTS  
TOTAL PARKING: 63 SPOTS

### CONSIDERATIONS:

- MOBILE CLASSROOMS REMOVED
- EXISTING PLAYGROUND REMAINS IN PLACE
- EXISTING HARDSCAPE WILL NEED TO BE MOVED/RECONSTRUCTED
- GYM IS NOT IDEAL SIZE DUE TO SETBACK (>5,000 sf)
- ADDITIONAL PARKING ALONG BRENTWOOD DR.
- PARKING LOT ENTRY NEEDS TO BE REWORKED AROUND NEW GYM

**\$9.1M**

NOTE: THESE ARE CONCEPT PLANS FOR DISCUSSION PURPOSES ONLY AND HAVE NOT BEEN REVIEWED OR APPROVED BY THE MT. PROSPECT PARK DISTRICT. THIS IS STRICTLY AN EXERCISE TO IDENTIFY ALL POSSIBLE OPTIONS THAT MAY OR MAY NOT EXIST.

1

BRENTWOOD ELEMENTARY SCHOOL EXPANSION STUDY - OPTION D1 (3-SECTIONS)

1" = 60'-0"







# BRENTWOOD EXPANSION DRAFT 10-23-23

## OPTION - E1 (3-SECTIONS)



- NEW ADDITION: 13,980 SF
- RENOVATION: 8,800 SF
- NEW PARKING: 14 SPOTS  
TOTAL PARKING: 69 SPOTS

### CONSIDERATIONS:

- MOBILE CLASSROOMS REMOVED
- REQUIRES DEMO & RENO AT FIRST FLOOR
- EXISTING HARDSCAPE WILL NEED TO BE MOVED/RECONSTRUCTED
- FULL SIZE GYM (5,000 SF)
- REQUIRES PURCHASE OF ADJACENT PROPERTY
- PARKING LOT ENTRY NEEDS TO BE EXPANDED
- ADDS KITCHEN & SERVERY
- EXPANDS LRC
- FUTURE READY

**\$14.0M**

NOTE: THESE ARE CONCEPT PLANS FOR DISCUSSION PURPOSES ONLY AND HAVE NOT BEEN REVIEWED OR APPROVED BY THE MT. PROSPECT PARK DISTRICT. THIS IS STRICTLY AN EXERCISE TO IDENTIFY ALL POSSIBLE OPTIONS THAT MAY OR MAY NOT EXIST.

1

### BRENTWOOD ELEMENTARY SCHOOL EXPANSION STUDY - OPTION E1 (3 SECTIONS)

1" = 60'-0"









0 45' 90'



COMMUNITY CONSOLIDATED  
SCHOOL DISTRICT 59

# BRENTWOOD EXPANSION PLANS

## DRAFT 10-23-23 - SUMMARY COMPARISON

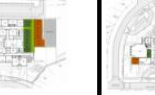
BRENTWOOD ELEMENTARY SCHOOL EXPANSION STUDY - CCSD 59 - WOLD ARCHITECTS AND ENGINEERS 10-23-23										
	EXISTING	OPTION A		OPTION B		OPTION C			OPTION D	OPTION E
										
	EXIST. PLAN	A1	A2	B1	B2	C1	C2	C3	D1	E1
<b>Option Criteria:</b>	Existing space program and utilization	Provide additional space program areas to satisfy immediate CRITICAL NEEDS to remove mobile classrooms and accommodate displaced classrooms	Provide additional space program areas to satisfy immediate CRITICAL NEEDS to remove mobile classrooms and accommodate displaced classrooms	Provide additional space program areas to address PRIORITY NEEDS and support current instructional methods. Includes new gym, band/orchestra room and student support spaces	Provide additional space program areas to address PRIORITY NEEDS and support current instructional methods. Includes new gym, band/orchestra room and student support spaces	Provide additional space program areas to address PRIORITY NEEDS and support current instructional methods. Includes new gym, band/orchestra room and student support spaces	Provide additional space program areas for FUTURE-READY LEARNING environment. Include priority list, plus kitchen and enhanced LRC	Provide additional space program areas for FUTURE-READY LEARNING environment. Include priority list, plus kitchen and enhanced LRC	Provides space program areas to address PRIORITY NEEDS with a 3-section grade level model	Provides space program areas for FUTURE-READY LEARNING with a 3-section grade level model
<b>CONSIDERATIONS</b>	Programming Notes	-	CRITICAL NEEDS ONLY	CRITICAL NEEDS ONLY	PRIORITY NEEDS GYM SIZE NOT IDEAL	PRIORITY NEEDS GYM SIZE NOT IDEAL	FUTURE-READY GYM SIZE NOT IDEAL	FUTURE-READY	PRIORITY NEEDS GYM SIZE NOT IDEAL	FUTURE-READY
	New Addition SF	-	4,630 SF	4,630 SF	13,100 SF	14,300 SF	29,180 SF	24,700 SF	8,100 SF	13,980 SF
	Renovation SF	-	0 SF	0 SF	765 SF	765 SF	3,310 SF	9,045 SF	6,800 SF	8,800 SF
	Project Budget	-	\$4.5M	\$4.5M	\$10.5M	\$11.2M	\$22.4M	\$22.0M	\$9.1M	\$14.0M
	Construction Timeline depends on design authorization and access	-	6 Month	6 Months	12 Months	12 Months	12 Months	12 Months	6 Months	12 Months
	Existing Playground	-	Relocated	No work	Relocated	No work	Relocated	Relocated	No work	Relocated
	Parking	53 spaces existing	None added	None added	(12) spaces added, includes on-street spaces	(12) spaces added, includes on-street spaces	(12) spaces added, includes on-street spaces	(14) off-street spaces added	(12) spaces added, includes on-street spaces	(14) off-street spaces added
	Building Construction	One-story	One-story additions	One-story addition	One-story addition	One-story addition	Two-story addition with partial demo	One-story addition	One-story addition	One-story addition
	Park District Property	Partial IGA	IGA for outdoor play areas	IGA for outdoor play areas	IGA for outdoor play areas	Land purchase	IGA for outdoor play areas	Land purchase	IGA for outdoor play areas	Land purchase
	Construction Phasing	-	Mobile remains during Construction	Mobile removed for Construction	Mobile removed for construction Courtyard construction difficult and disruptive Multiple additions (1) classroom displaced for Gym addition	Mobile removed for construction Courtyard construction difficult and disruptive Multiple additions (1) classroom displaced for Gym addition	Mobile removed for construction Two-story addition disruptive to remaining areas Multiple additions (5) classrooms displaced during construction	Mobile removed for construction Interior classroom renovation	Mobile removed for construction Multiple Additions Interior classroom renovation	Mobile removed for construction Interior classroom renovation



The logo for Wold, featuring the word "Wold" in white text on an orange, angular background.

Wold

# Q+A/DISCUSSION

A wide-angle photograph of a modern library interior. In the foreground, a young man sits in a blue armchair using a laptop. To his right, a young woman and a young boy sit on a grey sofa, also using laptops. Further right, another young man sits at a white desk, working on a laptop. In the background, a man in a blue shirt stands behind a long wooden service counter. The room is filled with bookshelves, colorful armchairs, and a patterned carpet. The ceiling has recessed fluorescent lights.





WORKING PROGRAM

	EXISTING BUILDING (as applicable)				MINIMAL IMPROVEMENTS (A1& A2)				PRIORITY IMPROVEMENTS (B1)				PRIORITY IMPROVEMENTS (B2)			
	Qty	Size	Total SF	Comments	Qty	Size	Total SF	Comments	Qty	Size	Total SF	Comments	Qty	Size	Total SF	Comments
<b>GRADE LEVEL INSTRUCTION</b>																
First thru Fifth Grade Classrooms	19	750	14,250 SF	vary in size	20	existing to remain			19	existing to remain			19	existing to remain		
Kindergarten Classrooms (w/ toilet)	2	960	1,920 SF		2	existing to remain			2	existing to remain			2	existing to remain		
Kindergarten Classrooms	1	890	890 SF (1) w/o toilet		2	1,200	2,400 SF (2) new w/ toilet		2	1,200	2,400 SF (2) new w/ toilet		2	1,200	2,400 SF (2) new w/ toilet	
Classroom	0	-	0 SF		0	-	0 SF		1	900	900 SF		1	900	900 SF	
<b>Grade Level Instruction Net Area Total</b>	22		17,060 SF		24		2,400 SF		24		3,300 SF		24		3,300 SF	
<i>Missing Touching Stations</i>	2				-				-				-			
<b>SPECIAL EDUCATION/INTERVENTION</b>																
ESL Intervention Classroom	4	200	800 SF	vary in size	4	existing to remain			4	455	1,820 SF		4	455	1,820 SF	
Math Intervention	2	740	1,480 SF		2	existing to remain			2	existing to remain			2	existing to remain		
Talent Development Program (TDP)		shared w/ conference room				shared w/ conference room			1	relocate to ESL spaces			1	relocate to ESL spaces		
Sensory Room	0	-	0 SF		0	-	0 SF		1	455	455 SF		1	455	455 SF	
SLP/Intervention Offices	4	130	520 SF	vary in size	4	existing to remain			4	relocate to ESL spaces			4	relocate to ESL spaces		
Intervention Office	2	150	300 SF	vary in size	2	existing to remain			2	existing to remain			2	existing to remain		
Literary Office	1	160	160 SF		1	existing to remain			1	existing to remain			1	existing to remain		
Speech	1	225	225 SF		1	existing to remain			1	relocate to ESL space			1	relocate to ESL space		
Offices	2	100	200 SF	vary in size	2	existing to remain			4	relocate to SLP space			4	relocate to SLP space		
<b>Special Education Net Area Total</b>	16		3,685 SF		16		0 SF		20		2,275 SF		20		2,275 SF	
<i>Missing (or shared) Programmatic Space</i>	2				2				-				-			
<b>EXPLORATORY</b>																
Art	1	750	750 SF	in mobile	1	900	900 SF		1	900	900 SF		1	900	900 SF	
Music	1	750	750 SF	in mobile	1	900	900 SF		1	900	900 SF		1	900	900 SF	
Gymnasium (existing)	1	2,860	2,860 SF		1	existing to remain			1	existing to remain			1	existing to remain		
Gymnasium (new)	0	-	0 SF		0	-	0 SF		1	3,370	3,370 SF		1	3,370	3,370 SF	
Gym Office	1	160	160 SF		1	existing to remain			1	existing to remain			1	existing to remain		
Gym Storage	1	175	175 SF		1	existing to remain			1	existing to remain			1	existing to remain		
Band/Orchestra		shared w/ conference room				shared w/ conference room			1	900	900 SF		1	900	900 SF	
LRC	1	2,840	2,840 SF		1	existing to remain			1	existing to remain			1	existing to remain		
LRC Office	1	225	225 SF		1	existing to remain			1	existing to remain			1	existing to remain		
LRC (enlarged)	0	-	0 SF		0	-	0 SF		0	-	0 SF		0	-	0 SF	
<b>Exploratory Net Area Total</b>	5		7,760 SF		7		1,800 SF		9		6,070 SF		9		6,070 SF	
<i>Missing (or shared) Programmatic Space</i>	5				3				1				1			
<b>BUILDING SUPPORT AND ADMINISTRATION</b>																
Main Office	1	600	600 SF		1	existing to remain			1	existing to remain			1	existing to remain		
Offices	2	150	300 SF		2	existing to remain			2	existing to remain			2	existing to remain		
Nurse	1	270	270 SF		1	existing to remain			1	existing to remain			1	existing to remain		
Conference Room	1	420	420 SF		1	existing to remain			1	existing to remain			1	existing to remain		
Staff Workroom	1	1,400	1,400 SF		1	existing to remain			1	existing to remain			1	existing to remain		
Staff Lounge		shared w/ workroom				shared w/ workroom				shared w/ workroom				shared w/ workroom		
Professional Development (PLC)	0	-	0 SF		0	-	0 SF		0	-	0 SF		0	-	0 SF	
Cafeteria/MRP	1	3,490	3,490 SF		1	existing to remain			1	existing to remain			1	existing to remain		
Warming Kitchen and Severy	1	170	170 SF		1	existing to remain			1	existing to remain			1	existing to remain		
Boiler/Electrical Room	1	1,260	1,260 SF		1	existing to remain			1	existing to remain			1	existing to remain		
Sever Room	1	250	250 SF		1	existing to remain			1	existing to remain			1	existing to remain		
<b>Building Support and Administration Net Area Total</b>			8,160 SF				0 SF				0 SF				0 SF	
<b>TOTAL AREAS</b>																
GRADE LEVEL INSTRUCTION			17,060 SF				2,400 SF				3,300 SF				3,300 SF	
SPECIAL EDUCATION/INTERVENTION			3,685 SF				0 SF				2,275 SF				2,275 SF	
EXPLORATORY			7,760 SF				1,800 SF				6,070 SF				6,070 SF	
BUILDING SUPPORT AND ADMINISTRATION			8,160 SF				0 SF				0 SF				0 SF	
<b>Total Net Square Footage</b>			36,665 SF				4,200 SF				11,645 SF				11,645 SF	
Net/Gross Factor		x	1.48			x	1.10			x	1.12			x	1.23	
<b>Total Gross Square Footage</b>			54,148 SF				4,630 SF				13,100 SF				14,300 SF	





WORKING PROGRAM

	FUTURE-READY IMPROVEMENTS (C1)				FUTURE-READY IMPROVEMENTS (C2)				FUTURE-READY IMPROVEMENTS (C3)			
	Qty	Size	Total SF	Comments	Qty	Size	Total SF	Comments	Qty	Size	Total SF	Comments
<b>GRADE LEVEL INSTRUCTION</b>												
First thru Fifth Grade Classrooms	13	existing to remain			15	existing to remain			15	existing to remain		
Kindergarten Classrooms (w/ toilet)	2	existing to remain			2	existing to remain			2	existing to remain		
Kindergarten Classrooms	2	1,200	2,400 SF	build new w/	2	1,200	2,400 SF	build new w/	2	1,200	2,400 SF	build new w/
Classroom	6	900	5,400 SF		6	900	5,400 SF		6	900	5,400 SF	
<b>Grade Level Instruction Net Area Total</b>	25		9,600 SF		25		7,800 SF		25		7,800 SF	
<i>Missing Teaching Stations</i>	-				-				-			
<b>SPECIAL EDUCATION/INTERVENTION</b>												
ESL Intervention Classroom	4	455	1,820 SF		4	renovate CR space			4	renovate CR space		
Math Intervention	2	existing to remain			2	existing to remain			2	existing to remain		
Talent Development Program (TDP)	1	455	455 SF		1	renovate CR space			1	renovate CR space		
Sensory Room	1	455	455 SF		1	renovate CR space			1	renovate CR space		
SLP/Intervention Offices	4	relocate to ESL spaces			4	relocate to ESL spaces			4	relocate to ESL spaces		
Intervention Office	2	existing to remain			2	existing to remain			2	existing to remain		
Literary Office	1	existing to remain			1	existing to remain			1	existing to remain		
Speech	1	relocate to ESL space			1	relocate to ESL space			1	relocate to ESL space		
Offices	4	relocate to SLP space			4	relocate to SLP space			4	relocate to SLP space		
<b>Special Education Net Area Total</b>	20		2,730 SF		20		0 SF		20		0 SF	
<i>Missing (or shared) Programmatic Space</i>	-				-				-			
<b>EXPLORATORY</b>												
Art	1	900	900 SF		1	900	900 SF		1	900	900 SF	
Music	1	900	900 SF		1	900	900 SF		1	900	900 SF	
Gymnasium (existing)	1	existing to remain			1	existing to remain			1	existing to remain		
Gymnasium (new)	1	3,370	3,370 SF		1	5,000	5,000 SF		1	5,000	5,000 SF	
Gym Office	1	existing to remain			1	existing to remain			1	existing to remain		
Gym Storage	1	existing to remain			1	existing to remain			1	existing to remain		
Band/Orchestra	1	1,200	1,200 SF		1	1,200	1,200 SF		1	1,200	1,200 SF	
LRC	1	existing to remain			1	existing to remain			1	existing to remain		
LRC Office	1	existing to remain			1	existing to remain			1	existing to remain		
LRC (enlarged)	1	renovate to increase SF			1	renovate to increase SF			1	renovate to increase SF		
<b>Exploratory Net Area Total</b>	10		6,370 SF		10		8,000 SF		10		8,000 SF	
<i>Missing (or shared) Programmatic Space</i>	-				-				-			
<b>BUILDING SUPPORT AND ADMINISTRATION</b>												
Main Office	1	existing to remain			1	existing to remain			1	existing to remain		
Offices	2	existing to remain			2	existing to remain			2	existing to remain		
Nurse	1	existing to remain			1	existing to remain			1	existing to remain		
Conference Room	1	existing to remain			1	existing to remain			1	existing to remain		
Staff Workroom	1	renovate staff wrkrm			1	renovate staff wrkrm			1	renovate staff wrkrm		
Staff Lounge	1	renovate staff wrkrm			1	renovate staff wrkrm			1	renovate staff wrkrm		
Professional Development (PLC)	1	accommodated in LRC			1	accommodated in LRC			1	accommodated in LRC		
Cafeteria/MRP	1	existing to remain			1	existing to remain			1	existing to remain		
Warming Kitchen and Severy	1	800	800 SF		1	800	800 SF		1	800	800 SF	
Boiler/Electrical Room	1	existing to remain			1	existing to remain			1	existing to remain		
Sever Room	1	existing to remain			1	existing to remain			1	existing to remain		
<b>Building Support and Administration Net Area Total</b>			800 SF				800 SF				800 SF	
<b>TOTAL AREAS</b>												
GRADE LEVEL INSTRUCTION			9,600 SF				7,800 SF				7,800 SF	
SPECIAL EDUCATION/INTERVENTION			2,730 SF				0 SF				0 SF	
EXPLORATORY			6,370 SF				8,000 SF				8,000 SF	
BUILDING SUPPORT AND ADMINISTRATION			800 SF				800 SF				800 SF	
<b>Total Net Square Footage</b>			19,500 SF				16,600 SF				16,600 SF	
Net/Gross Factor	x	1.50			x	1.49			x	1.29		
<b>Total Gross Square Footage</b>			29,180 SF				24,700 SF				21,350 SF	



WORKING PROGRAM

GRADE LEVEL INSTRUCTION

First thru Fifth Grade Classrooms  
Kindergarten Classrooms (w/ toilet)  
Kindergarten Classrooms  
Classroom

**Grade Level Instruction Net Area Total**  
*Missing Teaching Stations*

SPECIAL EDUCATION/INTERVENTION

ESL Intervention Classroom  
Math Intervention  
Talent Development Program (TDP)  
Sensory Room  
SLP/Intervention Offices  
Intervention Office  
Literary Office  
Speech  
Offices

**Special Education Net Area Total**  
*Missing (or shared) Programmatic Space*

EXPLORATORY

Art  
Music  
Gymnasium (existing)  
Gymnasium (new)  
Gym Office  
Gym Storage  
Band/Orchestra  
LRC  
LRC Office  
LRC (enlarged)

**Exploratory Net Area Total**  
*Missing (or shared) Programmatic Space*

BUILDING SUPPORT AND ADMINISTRATION

Main Office  
Offices  
Nurse  
Conference Room  
Staff Workroom  
Staff Lounge  
Professional Development (PLC)  
Cafeteria/MRP  
Warming Kitchen and Severy  
Boiler/Electrical Room  
Sever Room

**Building Support and Administration Net Area Total**

TOTAL AREAS

GRADE LEVEL INSTRUCTION  
SPECIAL EDUCATION/INTERVENTION  
EXPLORATORY  
BUILDING SUPPORT AND ADMINISTRATION  
**Total Net Square Footage**

Net/Cross Factor

**Total Gross Square Footage**

PRIORITY IMPROVEMENTS (D1)			
3-SECTIONS			
Qty	Size	Total SF	Comments
16	existing to remain		
2	existing to remain		
1	1,200	1,200 SF build new w/	
0	-	0 SF	
19		1,200 SF	
-			
4	relocate to CR spaces		
2	existing to remain		
1	renovate CR space		
1	renovate CR space		
4	relocate to ESL spaces		
2	existing to remain		
1	existing to remain		
1	relocate to ESL space		
4	relocate to SLP space		
20		0 SF	
-			
1	900	900 SF	
1	900	900 SF	
1	existing to remain		
1	3,370	3,370 SF	
1	existing to remain		
1	existing to remain		
1	900	900 SF	
1	existing to remain		
1	existing to remain		
0	-	0 SF	
9		6,070 SF	
1			
1	existing to remain		
2	existing to remain		
1	existing to remain		
1	existing to remain		
1	existing to remain		
0	-	0 SF	
1	existing to remain		
1	existing to remain		
1	existing to remain		
1	existing to remain		
0	-	0 SF	
		0 SF	
		1,200 SF	
		0 SF	
		6,070 SF	
		0 SF	
		7,270 SF	
	x	1.11	
		8,100 SF	

FUTURE-READY IMPROVEMENTS (E1)			
3-SECTIONS			
Qty	Size	Total SF	Comments
15	existing to remain		
2	existing to remain		
1	1,200	1,200 SF build new w/	
1	900	900 SF	
19		2,100 SF	
-			
4	relocate to CR spaces		
2	existing to remain		
1	renovate CR space		
1	renovate CR space		
4	relocate to ESL spaces		
2	existing to remain		
1	existing to remain		
1	relocate to ESL space		
4	relocate to SLP space		
20		0 SF	
-			
1	900	900 SF	
1	900	900 SF	
1	existing to remain		
1	5,000	5,000 SF	
1	existing to remain		
1	existing to remain		
1	1,200	1,200 SF	
1	existing to remain		
1	existing to remain		
1	renovate to increase SF		
10		8,000 SF	
-			
1	existing to remain		
2	existing to remain		
1	existing to remain		
1	existing to remain		
1	renovate staff wrkrm		
1	renovate staff wrkrm		
1	accommodated in LRC		
1	existing to remain		
1	800	800 SF	
1	existing to remain		
1	existing to remain		
		800 SF	
		2,100 SF	
		0 SF	
		8,000 SF	
		800 SF	
		10,900 SF	
	x	1.28	
		13,980 SF	